

REVISIONS					
CDW#	LTR	DESCRIPTION	DATE	REVISED	APPROVED
-	A	INITIAL RELEASE			
6		TEMP CONTROL UPGRADE	11/21/17	KLH	J VELEZ

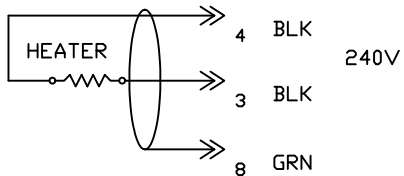

120V

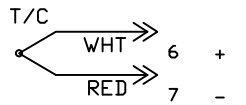
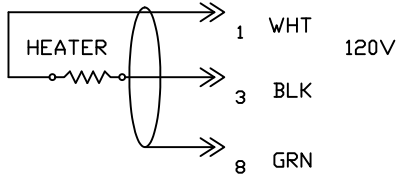
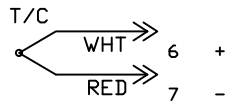
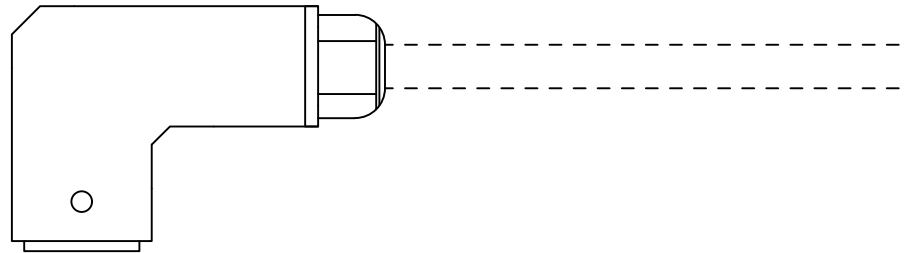
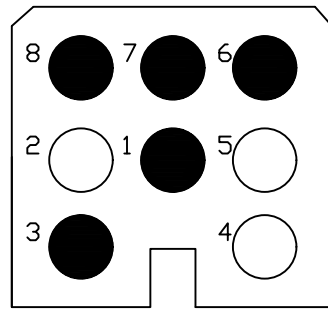

FACE VIEW

PIN OUT  
 1. N  
 3. L1  
 6. T.C.+  
 7. T.C.-  
 8. GRD

240V

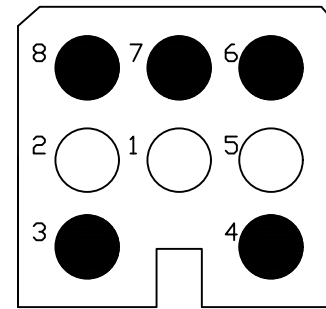

FACE VIEW

PIN OUT  
 3. L1  
 4. L2  
 6. T.C.+  
 7. T.C.-  
 8. GRD

		<small>THIS PRINT IS THE PROPERTY OF SONITEK AND REPRESENTS CONFIDENTIAL AND PROPRIETARY INFORMATION OF SONITEK. THEREFORE IT MAY NOT BE USED OR DISCLOSED IN ANY WAY WITHOUT THE EXPRESSED WRITTEN CONSENT OF SONITEK.</small>	
		<small>84 RESEARCH DRIVE, MILFORD, CT 06460        (203)-878-9321 FAX: (203)-878-6786</small>	
<small>DATE: 1/25/17</small>	<small>SHEET QTY: 1 of 1</small>	<small>MACHINE: HEATER</small>	
<small>DESIGNER: CP</small>	<small>DO NOT SCALE DRAWINGS</small>	<small>TITLE: PINOUT</small>	
<small>CUSTOMER: SONITEK</small>		<small>DRAWING NUMBER: SONITEK HEATER PINOUT</small>	
			<small>REV 6</small>